

CALVARY CHAPEL BLYTHE - PROPOSED FLOOR PLAN 'B'

Scale: 1/16" = 1'-0"

Total Building Area = 8,890 sq ft

CHARESTCORP
church design builders



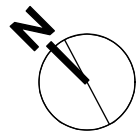
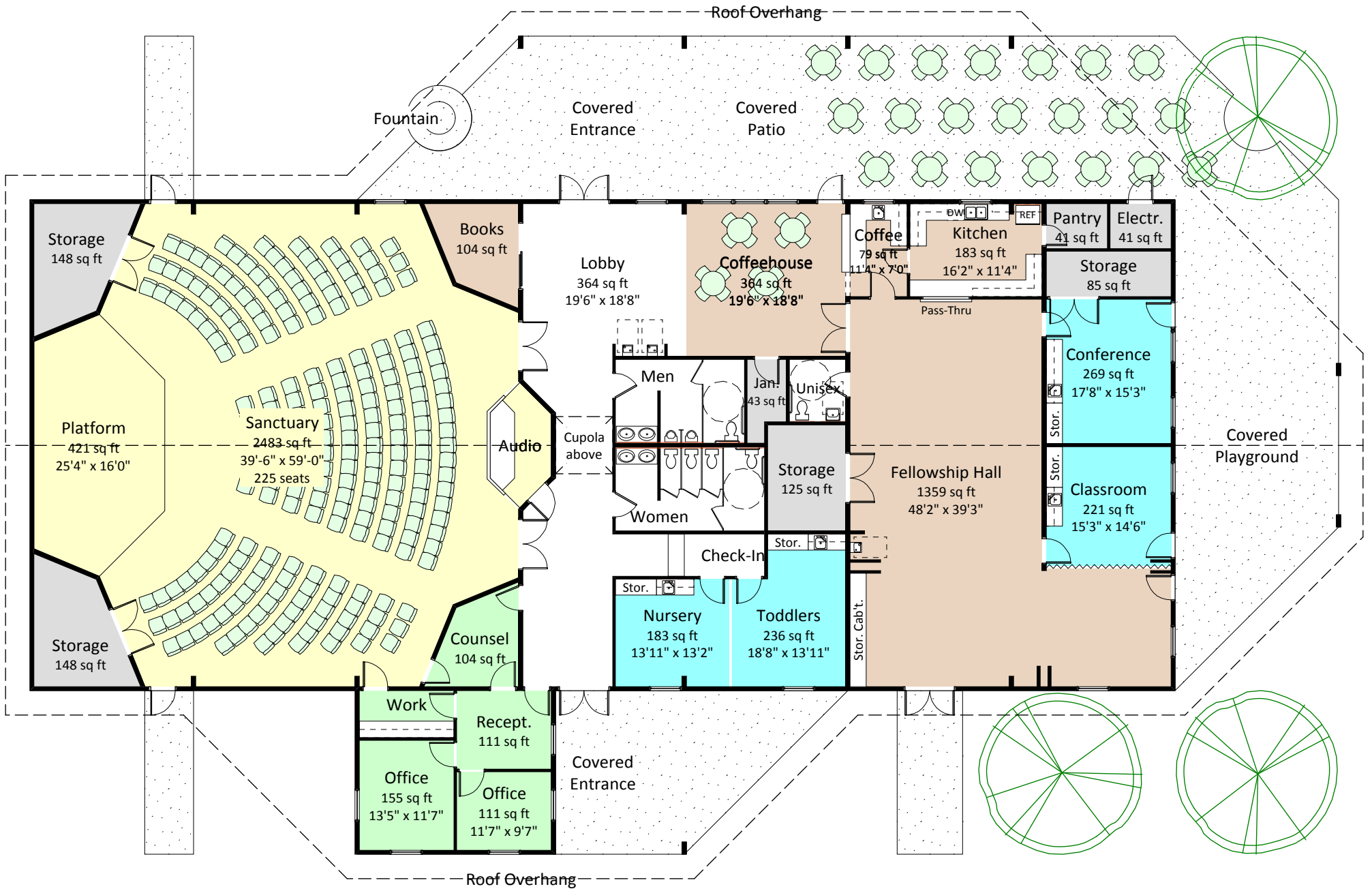

CALVARY CHAPEL BLYTHE - PROPOSED FLOOR PLAN 'C'

Scale: 1/16" = 1'-0"

Total Building Area = 8,890 sq ft

